

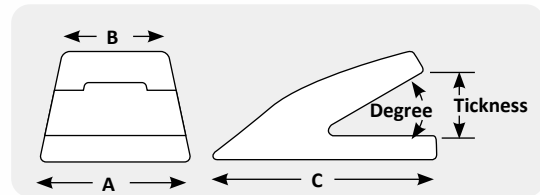

Lip, Heel and Corner Protection

Weld On Lip Shrouds

Part #	Weight	Lip Thickness	Degree	A	B	C
4ML50UC	14.6 lbs	1.25-2.00	30°	5.59"	5.15"	8.12"
10WS	19.6 lbs	1.50"	30°	10.00"	7.00"	7.38"
13WS	40.7 lbs	1.75"	23°	13.00"	10.00"	10.25"
WS25	4.0 lbs	1.75"	22°	2.50"	2.50"	4.88"
WS45	14.2 lbs	1.75-2.00"	30°	4.50"	4.50"	7.17"
WLS2003024	122.1 lbs	2.00"	30°	24.00"	24.00"	9.18"
WLS2503024	171.1 lbs	2.50"	30°	24.00"	24.00"	11.33"
WS80	33.4 lbs	2.50"-3.00"	30°	8.00"	7.00"	8.57"
4ML70UC	45.3 lbs	2.50"-3.00"	30°	9.47"	8.93"	9.49"
WLS3003024	202.6 lbs	3.00"	30°	24.00"	24.00"	12.72"
4599824BC	19.1 lbs	3.15"	22°	2.28"	2.28"	12.17"
WLS3503024	271.6 lbs	3.50"	30°	24.00"	24.00"	14.74"
WLS4003024	417.1 lbs	4.00"	30°	24.00"	24.00"	17.46"
STR120UC	85.2 lbs	4.00"-4.75"	30°	12.16"	10.40"	9.23"
STR120LD	83.3 lbs	4.00"-4.75"	30°	11.90"	9.50"	9.14"
STR120RD	83.9 lbs	4.00"-4.75"	30°	11.90"	9.50"	9.14"



Weld On Heel Shrouds

Part #	Description	Weight	A	B	C	D
CG03	Cast Corner	5.4 lbs	3.00"	4.12"	3.62"	0.75"
2804079	Heel Shroud - Curved	9.3 lbs	4.70"	5.90"	4.30"	0.79"
2804078	Heel Shroud - Straight	10.8 lbs	4.70"	5.90"	4.30"	0.79"
ES6697-4	Heel Shroud- Curved	22.4 lbs	7.49"	7.00"	4.00"	1.24"
1386551	Heel Shroud - Curved	26.9 lbs	6.88"	8.13"	5.88"	1.00"
ST002	Heel Shroud - Curved	29.2 lbs	11.75"	4.00"	4.00"	1.00"
138 6529	Heel Shroud - Straight	29.6 lbs	6.88"	8.13"	5.88"	1.00"
ES6697-3	Heel Shroud- Curved	29.9 lbs	7.49"	7.00"	4.00"	1.24"
ST001	Heel Shroud	33.3 lbs	18.00"	4.00"	4.00"	1.00"
1571027	Heel Shroud - Curved	59.3 lbs	9.81"	10.63"	7.88"	1.19"
1571019	Heel Shroud	65.1 lbs	9.81"	10.63"	7.88"	1.19"
ES6697-5	Heel Shroud- Curved	87.5 lbs	9.99"	12.00"	8.00"	2.00"
ES6697-7	Heel Shroud	189.5 lbs	9.84"	13.70"	9.88"	3.94"

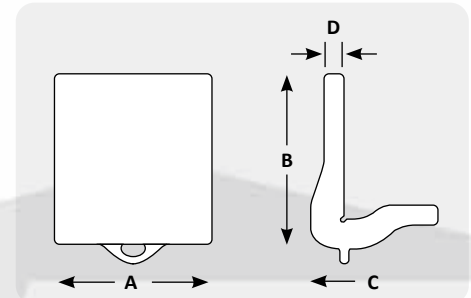

Corner Protectors

Part #	Description	Weight	Length	A	B	C
CG24-5	Round Edge	31.5 lbs	24.00"	3.88"	3.50"	0.63"
CG36-6	Square Edge	67.8 lbs	36.00"	4.13"	3.63"	0.75"

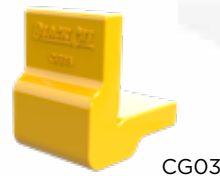
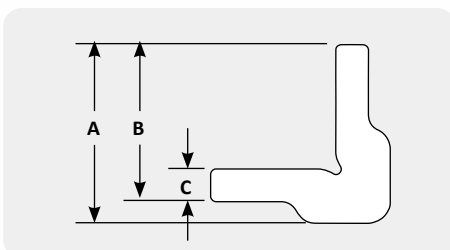

www.blackcatwearparts.com sales@blackcatwearparts.com Toll Free: 1.800.661.6666 T: 780.465.6666 F: 780.465.9595

Caterpillar® and other identities and/or trademarks referred to in this publication are the registered marks of the entities noted herein. The use of any trademarks of others than Black Cat Wear Parts Ltd. are solely and exclusively for identification, informational, comparative, and descriptive purposes. Black Cat Wear Parts Ltd. is not affiliated with any owner of such registered marks and does not make, use, or sell any products manufactured by any such entity identified in this publication.